

\$578,000 - 3109 112a Street, Edmonton

MLS® #E4434771

\$578,000

5 Bedroom, 4.00 Bathroom, 2,283 sqft
Single Family on 0.00 Acres

Sweet Grass, Edmonton, AB

Welcome to this Ace Lange Built Home in Sought-After Sweet Grass community! This 2,282 sq ft 2-storey home offers 5 bedrooms and 4 bathrooms, ideal for families seeking space, comfort, and convenience. The main floor features a bright open-concept kitchen and eating area that flows into a cozy family room with a gas fireplace and access to a covered patio—perfect for year-round enjoyment. The formal living and dining rooms showcase large bay windows that fill the space with natural light. A main floor bedroom offers flexibility as a guest room or home office, complemented by a full 3-piece bathroom and a functional laundry room with access to the double attached garage. Upstairs, you'll find 3 spacious bedrooms, including a large primary suite with 3-piece ensuite and patio doors to a private balcony. The fully finished basement includes a 5th bedroom, full bathroom, and rec room. Located close to schools, LRT, parks, and shopping. A perfect blend of comfort and location!

Built in 1977

Essential Information

MLS® #	E4434771
Price	\$578,000
Bedrooms	5

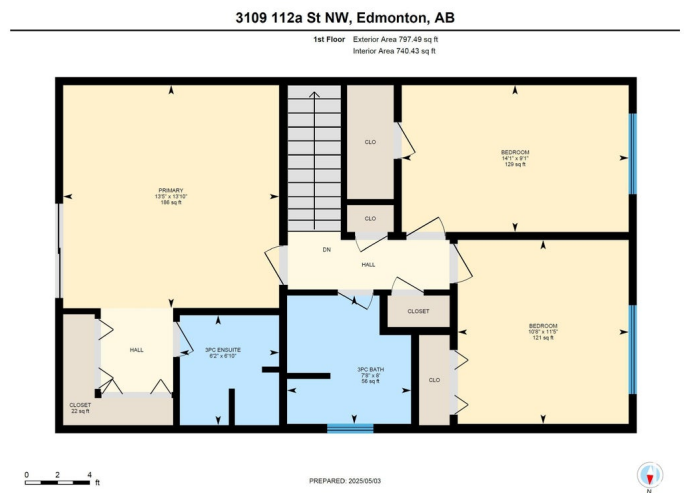
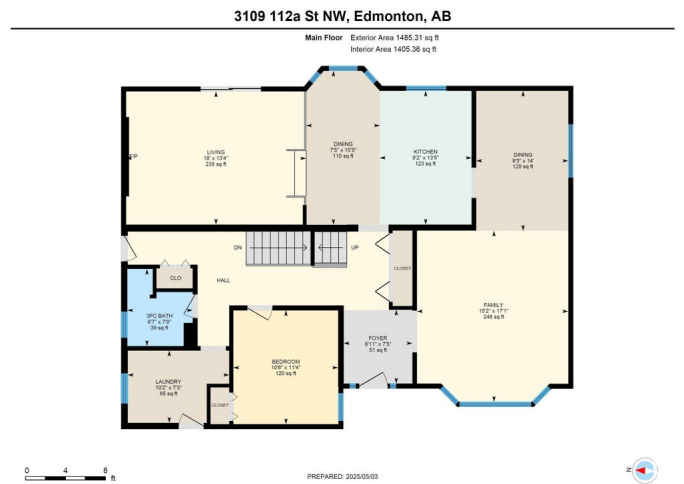

Bathrooms	4.00
Full Baths	4
Square Footage	2,283
Acres	0.00
Year Built	1977
Type	Single Family
Sub-Type	Detached Single Family
Style	2 Storey
Status	Active

Community Information

Address	3109 112a Street
Area	Edmonton
Subdivision	Sweet Grass
City	Edmonton
County	ALBERTA
Province	AB
Postal Code	T6J 4G9

Amenities

Amenities	See Remarks
Parking	Double Garage Attached

Interior

Interior Features	ensuite bathroom
Appliances	Dishwasher-Built-In, Dryer, Hood Fan, Refrigerator, Stove-Electric, Washer, Window Coverings
Heating	Forced Air-1, Natural Gas
Stories	2
Has Basement	Yes
Basement	Full, Partially Finished

Exterior

Exterior	Wood, Brick
Exterior Features	See Remarks
Roof	Asphalt Shingles
Construction	Wood, Brick
Foundation	Concrete Perimeter

Additional Information

Date Listed May 6th, 2025

Days on Market 2

Zoning Zone 16

DATA IS DEEMED RELIABLE BUT IS NOT GUARANTEED ACCURATE BY THE REALTORS® ASSOCIATION OF EDMONTON. COPYRIGHT 2025 BY THE REALTORS® ASSOCIATION OF EDMONTON. ALL RIGHTS RESERVED. Trademarks are owned or controlled by the Canadian Real Estate Association (CREA) and identify real estate professionals who are members of CREA (REALTOR®, REALTORS®) and/or the quality of services they provide (MLS®, Multiple Listing Service®)

Listing information last updated on May 8th, 2025 at 12:47pm MDT